

CEMENT PLASTER JOB BUILT  
USING CASING BEADS OR "J"  
CHANNEL

PRE MADE FOAM -  
PRE-FINISHED OR JOB  
FINISHED

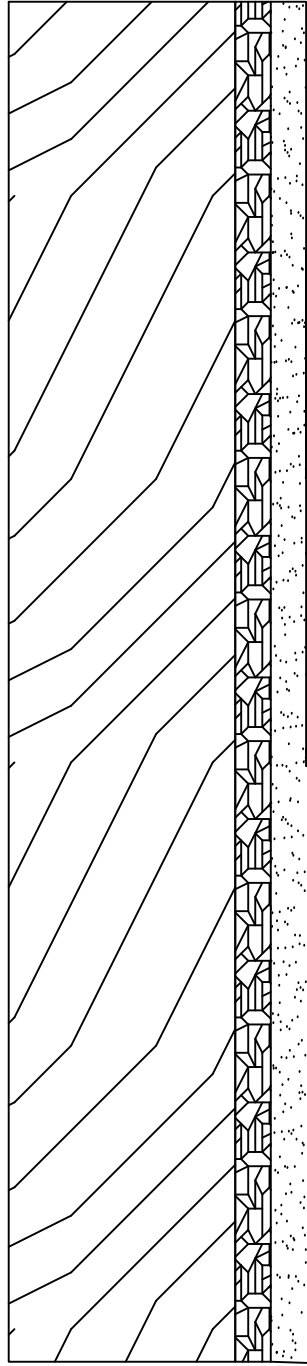

3/4" Cement Cladding over  
StructaLath or 3/8" Cement  
Cladding over CMU's  
Covered with two coats 12  
Mills DFT (min) Drylok  
Extreme

Fully Coated Wall  
(See Below)

Optional Sealant Line Top - Bottom can be sealed if desired

Cement or Acrylic Coated Decorative  
Foam Banding, Quoin or Trim

Foam Adhesive  
Thickness expanded for  
visual - seal and paint if desired

### BANDS, APPLIQUE, QUOINS

Sealant Line Top - Bottom can be sealed if desired

Vinyl Casing Stop attached with spot adhesive  
6" o-c linearly Top and Bottom to form band or shape

Fill with cement mixed at a 1:5 ratio with 1/4 gallon of  
bonding agent per cubic foot added to the mix. Brush  
the area with bonding agent prior to the application  
of 2 lifts of the modified mix. Seal and paint with  
Drylok Extreme or other high quality Acrylic Latex

### DRAWING NTS

Note:  
Details to be used in conjunction with all  
applicable provisions contained in the  
Sealed Cladding System Design Manual.

Sealed Cladding System

SCS 07 \_05

07/01/2020